



Indigo Lime – E.P50C2-W – installation guide. Wall mount for PS5 (disk & digital)



Your parts

- Supports x2 (sided)
- Bridge
- Wall Mounting kit

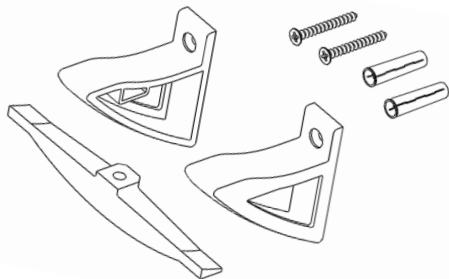

Note: You will need the screw that holds the base to the bottom of the console, so keep that handy.

! Do not over tighten
Please use hand screwdriver when installing.

Drill Guide

7mm drill bit needed

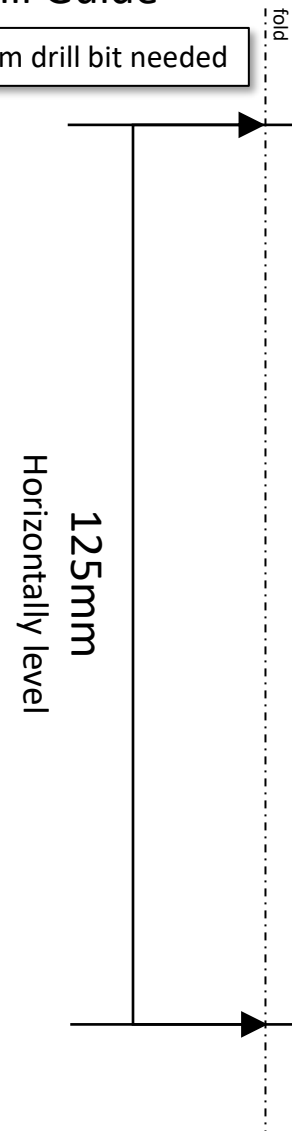

! CAUTION – your printer might not print to scale!

Wall mounting

1 – drill holes

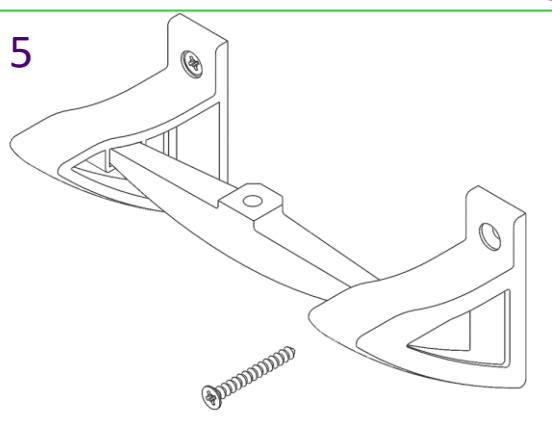
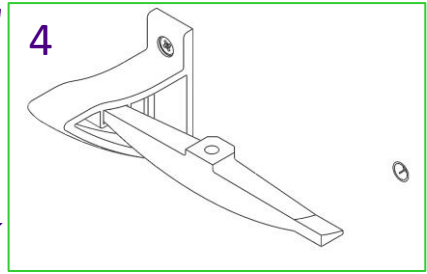
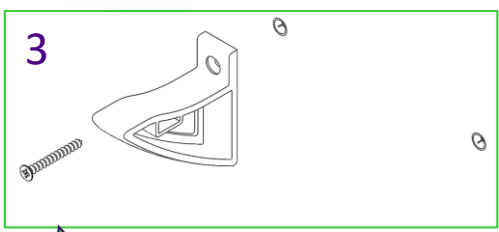
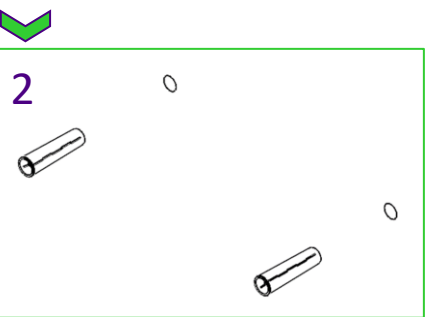

With the base attached to the back of the PS5, put it flat against the wall and lower onto the bracket. The bridge has some free play designed into it to allow easier fitting of the screw. Using the screw that comes with the PS5, tighten the bridge to the bottom of the PS5.

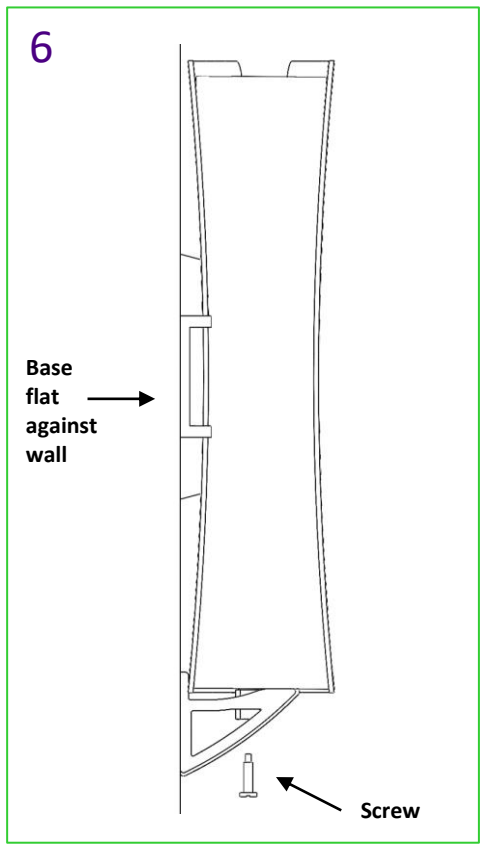

Visit indigolime.uk for more great products

It would be awesome if you could leave feedback. If you are not happy, please contact us *before* leaving negative feedback
We love to see your installations, send pic(s) to sales@indigolime.uk or Facebook: [@indigolime](https://www.facebook.com/indigolime)